

TECHNICAL DATASHEET

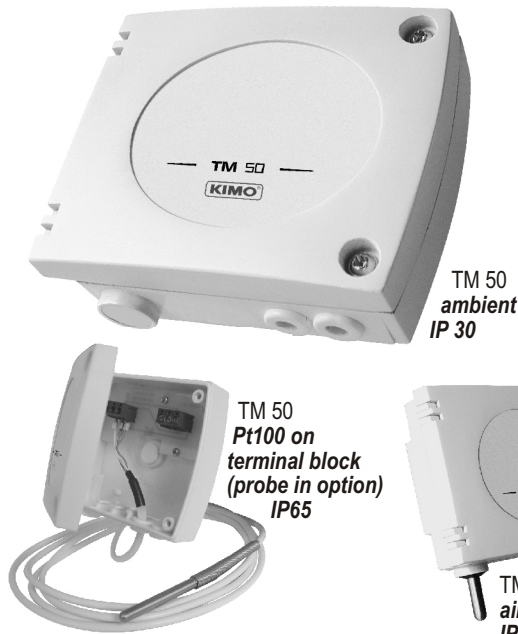

**Temperature transmitter
TM 50**

- Temperature transmitter type TM 50.
- Pt100 3 wires output
- ABS IP65 and IP 30 housing, without display
- Quick and easy mounting "1/4 turn" system with wall-mount plate.



Part number

To order, just add the code to complete the part number

Housing	
A	Ambient
B	Pt100 on terminal block
E	Air tight

TM 50 -

Example : TM 50-A
Model : temperature transmitter TM 50, ambient housing IP 30.

Dimensions

(with wall-mount plate)

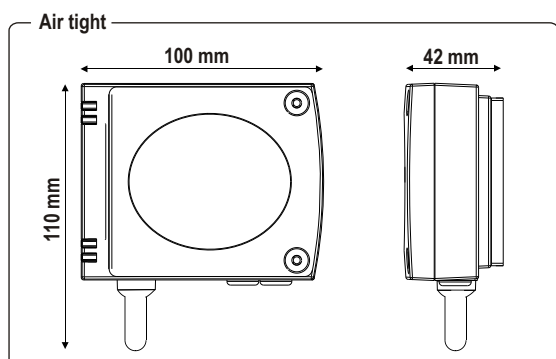
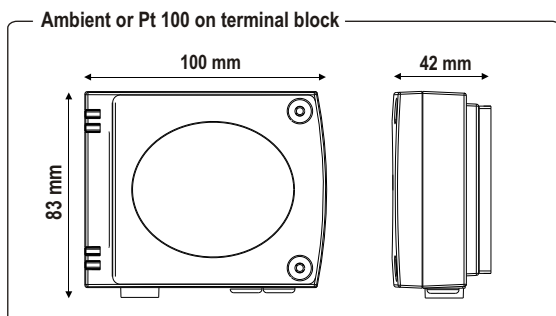

Features of the transmitter

Temperature

Working principle : Pt 100 is a resistance with a positive temperature coefficient which varies according to the temperature. The higher the temperature is, the more the value of the resistance increases.
Example : for 0°C \simeq 100 Ω - for 100°C \simeq 138,5 Ω

Measuring range	-20 to +80°C (air tight model) +10 à +40°C (ambient model) depending on the probe (Pt100 on terminal block)
Accuracy*	Pt100 class A as per DIN IEC751
Response time	1/e (63%) 5 sec. (ambient model) 1/e (63%) 20 sec. (air tight model) depending on the probe (Pt100 on terminal block)
Type of fluid	air and neutral gases

Features of the housing

Housing	ABS
Fire-proof classification	HB as per UL94
Dimensions	see drawing beside
Protection	IP 65 (air tight and Pt100 on terminal block models) IP 30 (ambient model)
Cable grip	for cables \varnothing 7 mm max.
Weight	110 g

Technical specifications

Output	Pt100 3 wires
Electrical connection	screw terminal block for cables \varnothing 1.5 mm ² max.
Working temperature	-20 to +80°C (air tight model) +10 to +40°C (ambient model) depending on the probe (Pt100 on terminal block)
Storage temperature	-10 to +70°C
Environment	air and neutral gases

*All the accuracies indicated in this technical datasheet were stated in laboratory conditions, and can be guaranteed for measurements carried out in the same conditions, or carried out with calibration compensation.

Connection



For the model
TM 50-B • Pt100 input and output on terminal block

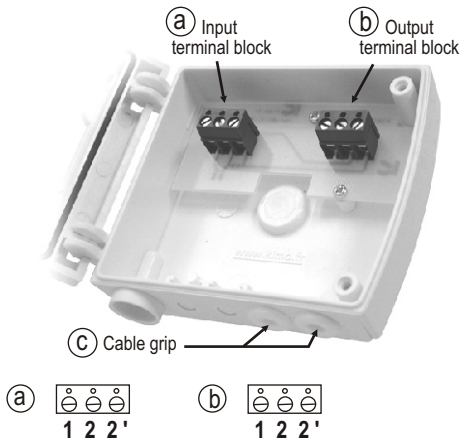

(C) Cable grip : to insert the cable, it is required to slightly cut the rubber.

For the model
TM 50-A • Pt100 output on terminal block

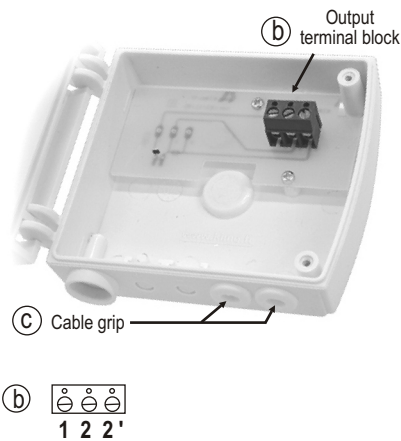

For the model
TM 50-E • Pt100 output on terminal block

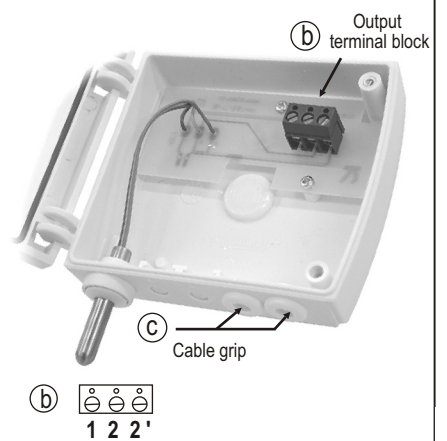

Pt 100 connections

⚠ This connection must be made by a qualified technician.

For the model
TM 50-B • Input and output Pt100 on terminal block

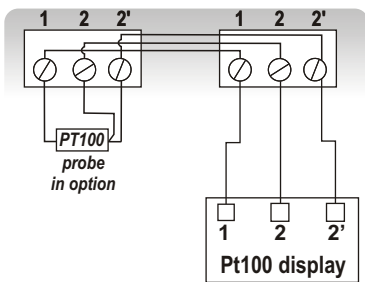

For the model
TM 50-A and **TM 50-E** • output Pt100 on terminal block

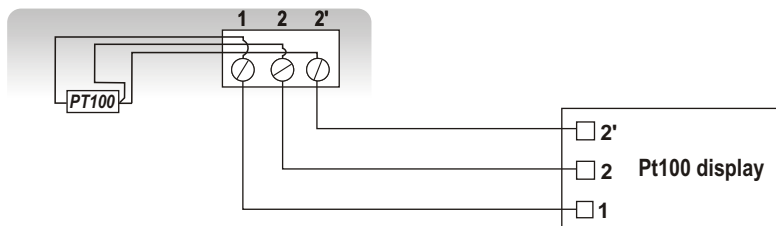

Mounting

Installation : mount the ABS plate on the wall (this plate is supplied with the transmitter).

Drilling : \varnothing 6 mm with the screws and pins supplied with the transmitter.

Insert the transmitter into the plate (see points A of the drawing shown beside), by tilting it at 30°. Rotate the housing in clockwise direction until you hear a "click" which confirms that the transmitter is correctly installed.

Maintenance

Please avoid any aggressive solvent.

Please protect the transmitter and its probes from any cleaning product containing formol, that may be used for cleaning rooms or ducts.

Options

- Temperature probes Pt100 3 wires

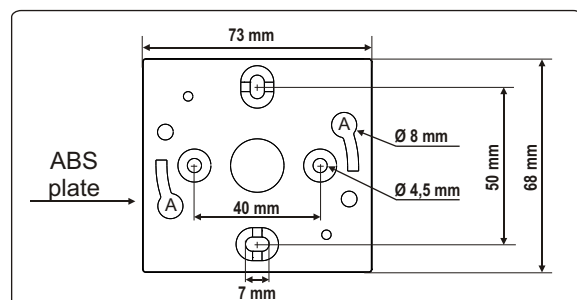

EXPORT DEPARTMENT

Tel : + 33. 1. 60. 06. 69. 25 - Fax : + 33. 1. 60. 06. 69. 29
site : www.kimo.fr e-mail : export@kimo.fr



Distributed by :